

## Olathe – Celebrating 160 Years

Olathe, founded in 1857  
by Dr. John T. Barton

- Olathe – Shawnee word meaning “beautiful”  
— name given by Barton and Shawnee Indian Dave Dougherty
- First home occupied by:  
Barton and Charles Osgood
- First female resident:  
Emily Whittier Millikan

### City of Olathe Established before Statehood

#### Soon Becomes a Prominent City

Dr. John T. Barton, a “town pioneer,” knew something about city planning. He envisioned a town near the center of Johnson County, ideally as the county seat. He designated the town center near the Santa Fe Trail crossing at Mill Creek where the renowned trail was already bringing traffic through the area. Olathe began with two quarter sections of land.

Born in Virginia, Barton came to Westport, Mo. in 1850, and was soon appointed surgeon for the Shawnee people. However, he had bigger dreams. In a few short years, he became a land speculator, grocer, hotel proprietor, drug

store and tavern owner. He served as treasurer of Johnson County, a delegate to the Wyandotte Constitutional Convention, and was a leader in the Democratic party.

Before Kansas became a state, the town of Olathe was thriving and outlasting hundreds of other towns that started in the young territory. The original town extended to Whitney Street on the north, Wabash Street on the south, Woodland Street on the east, and Iowa Street on the west.

Early Olathe settlers included: J.B. Mahaffie, Martin Ott, Jonathan Millikan, Charles Mayo, Ed Nash, and J. Henry Blake. By 1870, Olathe’s population was 341.

While the Johnson County seat was organized in Gum Springs, now Shawnee, it was permanently moved to Olathe in 1859, and continues to have a significant role in the city.

During the past 160 years, Olathe has experienced periods of astonishing growth

“He (Dr. John T. Barton) was of fine personal appearance, an accomplished physician, with a clear head and good judgment, and altogether was a person who would attain more than ordinary local importance in any community.”

*History of Johnson County, Kansas, 1874.*

and remains a desirable place to live. Olathe is now home to more than 136,000 residents. A new study indicates that most citizens choose to remain Olathe residents and purchase their second home in the city. In recent years, Olathe’s recognition includes one of the Best Places to Live in the U.S., a national leader in providing quality public services, and a community with outstanding opportunities for education and healthcare.

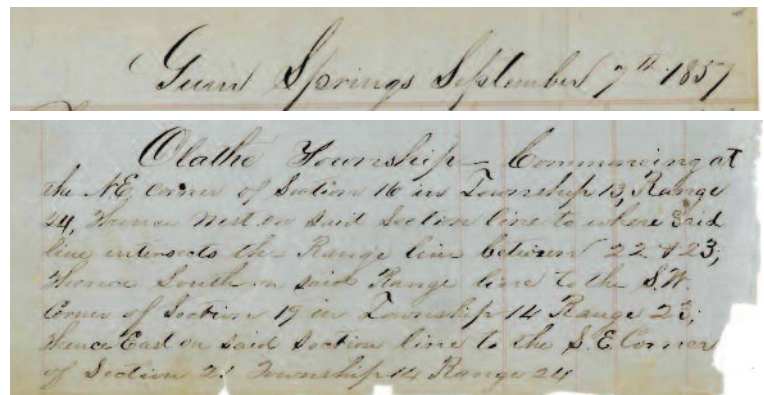

Olathe township record from Johnson County Archives



Find current Olathe news on the City’s website: [OlatheKS.org](http://OlatheKS.org).

### Inside This Issue

Mayor’s Message .....	2	Changes Coming to Downtown Olathe Skyline .....	5
Ward Boundary Adjustments .....	3	Olathe Earth News .....	6-7
Parks Plans Move Ahead .....	4	New OlatheKS.org .....	8



## Mayor's Message

# Celebrating a Milestone Birthday and Still Going Strong!



Our community will mark 160 years as the City of Olathe in 2017. Olathe's legacy is rich, and its people are among the finest on Earth. As we enter this milestone year, I'd like to reflect on our numerous successes leading into the new year.

More than ever, we are finding reasons to celebrate our diverse and vibrant city. We recognized outstanding residents at Olathe's 13th Annual Community Awards Program, presented by our Human Relations Commission and Persons with Disabilities Advisory Board. These award recipients are inspiring role models who advocate for equality and celebrate the differences and contributions of all citizens.

While the past year was challenging for those who serve in law enforcement, I am so proud of our residents' abundant support



and encouragement for the brave men and women of our Olathe Police Department. We thank these individuals for their community outreach and invaluable service in making

Olathe one of the top 10 safest cities in America.

Your safety and high quality of life remain our top priority. Our DirectionFinder® citizen surveys continue to affirm your satisfaction with our work for Olathe. We are first in our region in overall quality of City services and customer service, and eight out of 10 residents are satisfied with the value of services received for their tax dollars.

Olathe led Johnson County cities in single-family home building during 2016 — a continued testament to our quality of life, supported through exceptional schools and public services and a growing economy. Our dynamic city continues to see more jobs and investment, including expansions for Olathe Medical Center and GARMIN, as well as the opening of Menards, the KDC Data Center, and the Main Event family entertainment center. The City's purchase of the former Hy-Vee building at 135th and Brougham will provide more space for enhanced library services.

In 2017, we break ground on the redevelopment of Cedar Lake and Lake Olathe Parks, as well as the construction of Meadow Lane Trail. We will also move ahead on our new Public Art Master Plan. We are always looking for ways to improve and serve you better. Olathe is partnering with global experts through the *What Works Cities* initiative to share best practices for using data and performance measures to engage residents and improve services. See the *What Works Cities* article on page 8.

We've come a long way since 1857! The successes we share for Olathe are possible because of our community partnerships, collaboration, and your support. During this milestone year, we cannot forget the strong sense of civic pride and dedication of many who came before us.

Happy 160th birthday, Olathe!

Sincerely,

Michael Copeland  
Mayor

## Thank You Olathe! Mayor's Christmas Tree Fund Exceeds \$1 Million in Contributions Since 2007

The Olathe Mayor's Christmas Tree Fund is celebrating its best-ever campaign with a record total of \$183,000. This brings community contributions during the past 10 years to over \$1 million. Top donor Olathe Public Schools raised \$30,550.56 in their "Pennies for Shoes" drive, exceeding 2015 contributions by \$400.



*Prairie Trail Middle School 6th graders celebrate their successful "Pennies for Shoes" campaign. Prairie Trail made the highest campaign contribution in 2016.*

*We're celebrating this incredible achievement because our community truly cares about Olathe youth and families. Olatheans understand the importance of protecting our most vulnerable and investing in our future – our children.*

— Mayor Copeland



# Two Ward 3 Precincts Transfer to Ward 4

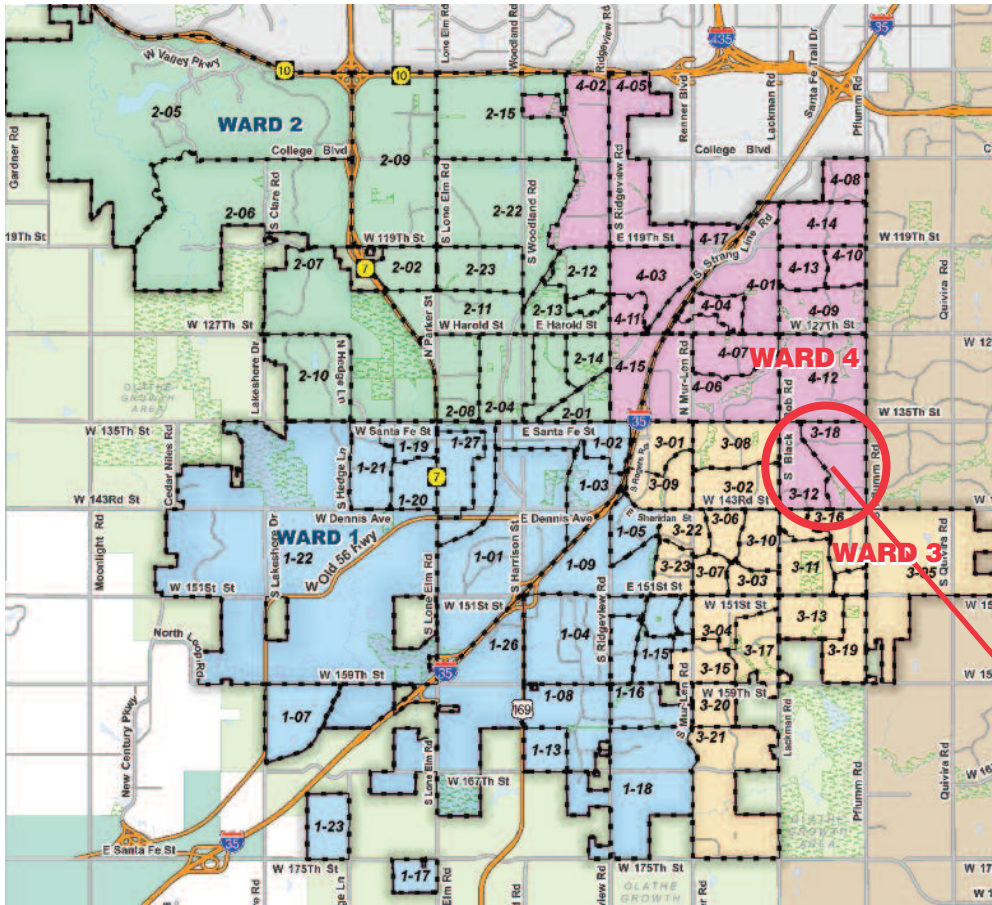

**Wes McCoy • Ward 3**  
913-269-1035 • [rwmccoy@olatheks.org](mailto:rwmccoy@olatheks.org)  
[OlatheKS.org/Government/City-Council](http://OlatheKS.org/Government/City-Council)



**Marge Vogt • Ward 4**  
913-269-0625 • [mvogt@olatheks.org](mailto:mvogt@olatheks.org)  
[OlatheKS.org/Government/City-Council](http://OlatheKS.org/Government/City-Council)

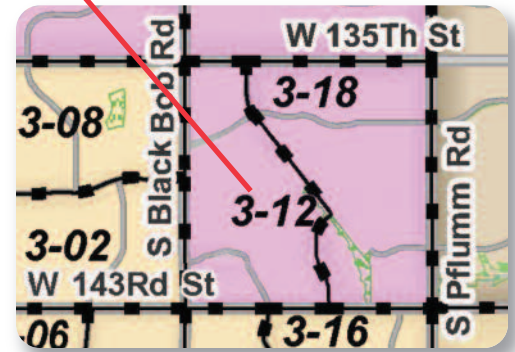

Olathe's continued population growth has prompted modification of City ward boundaries. Two precincts in Ward 3, 3-12 and 3-18, are now in Ward 4 following a recent transition to balance population boundaries. Ward 3 and Ward 4 had more than a 10 percent

variance from the ideal ward population. City Ordinance requires that City wards be nearly equal in population and as compact and contiguous as practical. Review of ward boundaries will occur again following the 2020 Census.

## Important City Phone Numbers

Regular Business Hours: Monday - Friday, 8 a.m. - 5 p.m.

Except for Emergency 911, and unless otherwise noted

**EMERGENCY** ..... 911

**Emergency TDD/TTY Calls** ..... 911

**GENERAL INFORMATION (TDD/Voice)** ..... 971-8600

### CUSTOMER SERVICE

1385 S. Robinson ..... 971-9311

Billing, Trash, Water & Sewer

### FIRE ADMINISTRATION

1225 S. Hamilton Circle (Non-Emergency) ..... 971-7900

Printed on recyclable paper.



[OlatheKS.org/CityDirectory](http://OlatheKS.org/CityDirectory)

### OLATHE PUBLIC LIBRARY

201 E. Park St. .... 971-6850  
13511 S. Mur-Len Rd. .... 971-6835

### PARKS AND RECREATION DEPARTMENT OLATHE COMMUNITY CENTER

1205 E. Kansas City Rd. (TDD/Voice) ... 971-8563

### POLICE DEPARTMENT

501 E. 56 Highway ..... 971-7500

### HUMAN RESOURCES

100 E. Santa Fe ..... 971-8735

## Olathe City Council

**Larry Campbell**  
Ward 1  
913-488-7278  
[lcampbell@olatheks.org](mailto:lcampbell@olatheks.org)

**Michael Copeland**  
Mayor  
913-971-8500  
(City office)  
[mcopeland@olatheks.org](mailto:mcopeland@olatheks.org)

**Jim Randall**  
Ward 2  
and Mayor Pro Tem  
913-424-3999  
[jrandall@olatheks.org](mailto:jrandall@olatheks.org)

**John Bacon**  
At Large  
913-269-6305  
[jbacon@olatheks.org](mailto:jbacon@olatheks.org)

**Wes McCoy**  
Ward 3  
913-269-1035  
[rwmccoy@olatheks.org](mailto:rwmccoy@olatheks.org)

**Ron Ryckman**  
At Large  
913-927-5333  
[rryckman@olatheks.org](mailto:rryckman@olatheks.org)

**Marge Vogt**  
Ward 4  
913-269-0625  
[mvogt@olatheks.org](mailto:mvogt@olatheks.org)

Stay Connected With Us





# 2016 Street Preservation Project Locations

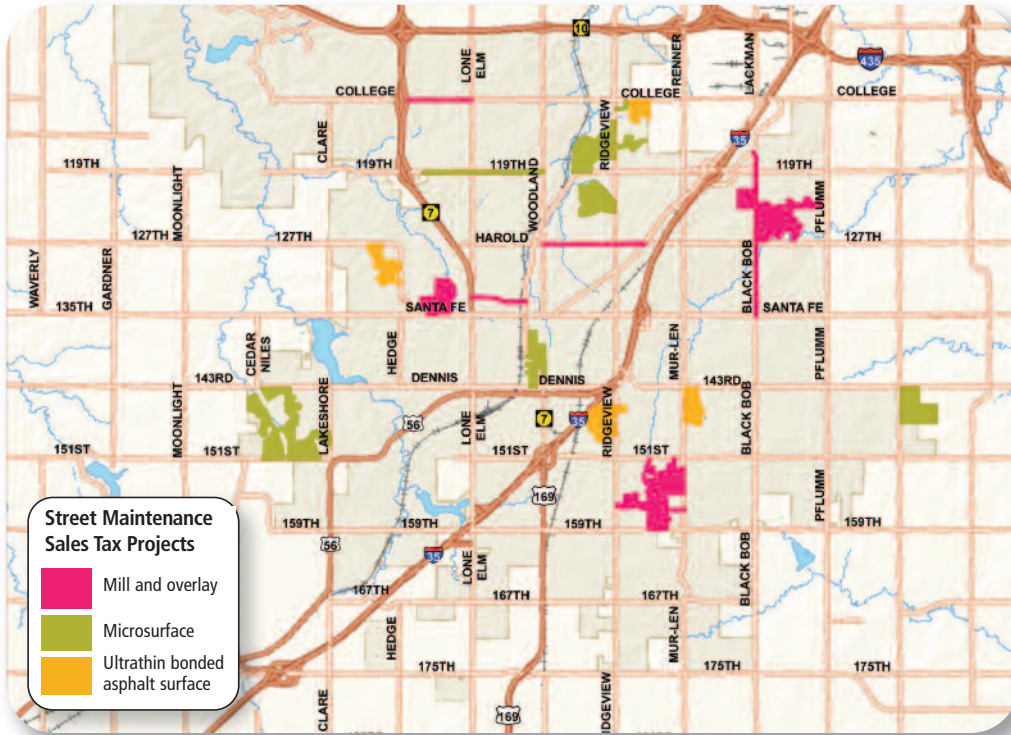

## Street Preservation in 2016

Resurfacing Type	Lane Miles
Arterial Street Mill and Overlay	16
Local/Collector Street Mill and Overlay	34
Surface Treatment	62

## More Olathe Street Preservation

Street preservation in the City of Olathe is a continuous process with 1,286 lanes miles to maintain throughout the city. The City of Olathe's goal is to maintain all Olathe streets in good or better condition. The cost of reconstructing streets far exceeds the cost of routine maintenance.

A map showing planned 2017 street maintenance will be available after Feb. 1 at: [OlatheKS.org/StreetPreservation](http://OlatheKS.org/StreetPreservation)



W. 158th Street – Before 2016 Mill and Overlay



W. 158th Street – After 2016 Mill and Overlay

## Major Olathe Park Plans Move Ahead in 2016

The voter-approved Olathe Park Sales Tax is supporting work on several park projects throughout the city.

During 2016, the Olathe City Council approved master plans for Cedar Lake Park, 15500 S. Lone Elm Rd., and Lake Olathe Park, 625 S. Lakeshore Dr. Improvements will get underway at these community parks in 2017.

See the lake master plans and details about the park features at [OlatheKS.org/ParksRecMasterPlan](http://OlatheKS.org/ParksRecMasterPlan)

Park planning and design moved forward as community partners and park user groups provided important input for continued improvements at:

- Lone Elm Park
- Prairie Center Park
- Black Bob Park
- Olathe Girls Softball Association Complex

In 2016, design was completed on the Meadow Lane Trail in north-central Olathe with construction to start in 2017. This trail will begin just south of the Kansas State University — Olathe campus on College Boulevard and extend north and east to the Gary Haller Trail accessed off of Ridgeview Road.

Arbor Landing Park, 16305 S. Lindenwood, will be dedicated in spring 2017. It is Olathe's newest neighborhood park featuring shelters, a playground, green space, fitness equipment, and a loop trail. In the future, the trail will connect to the Indian Creek Trail. Arbor Landing Park is funded by the Park Excise Tax, paid by developers to support neighborhood park development.

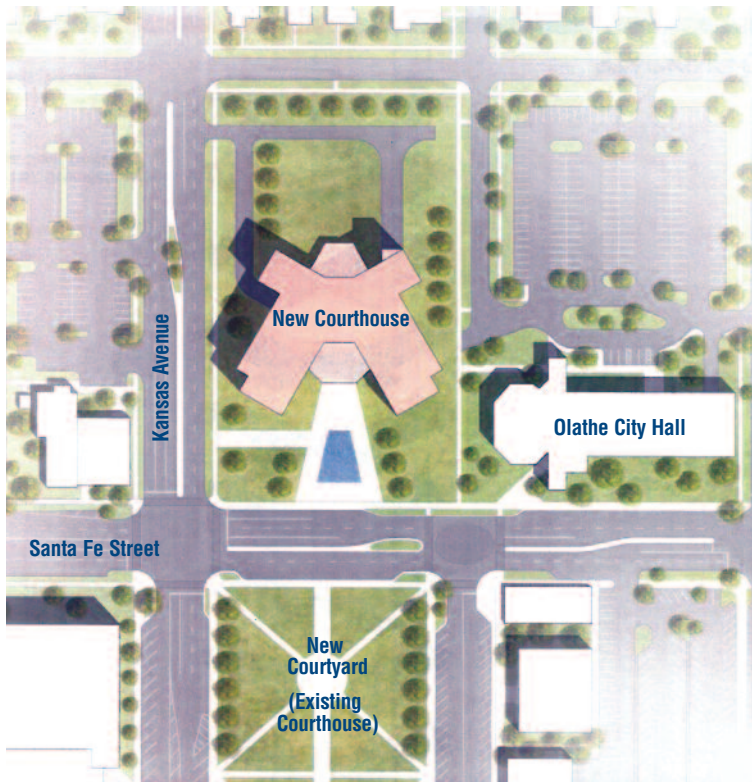

## Changes Coming to Downtown Olathe Skyline

Downtown Olathe will be home to a new Johnson County courthouse following November’s voter approval of a 10-year public safety sales tax. The new building will be located directly north of the existing courthouse at the northeast corner of Kansas Avenue and Santa Fe. The City of Olathe is contributing property at this location.

The courthouse will have 28 courtrooms with the option to expand to 32. Nine stories will be the maximum height of the new building, and it may be fewer depending on the final design. The current courthouse is four stories on the south and part of the east side, while the west and north sides are three stories. The tower portion is eight stories.

Existing structures on the new courthouse site will be razed, as will the existing courthouse. Dedicated green space is planned to replace the current courthouse site.

The Johnson County public safety tax is also funding a new coroner’s facility planned on County property near 119th Street and Sunset.

Public engagement about both projects’ design is planned early in the design phase in the beginning of 2018. Construction of both projects is expected to start in the first half of 2018. Expected completion of the courthouse is in 2021 and the coroner facility in 2020.



## Indian Creek Library

**Your Library is much more than books. Find inspiration, resources, and activities at the Indian Creek Library.**

Indian Creek Library temporary location:  
13511 S. Mur-Len Rd., near Savers | 913-971-6835

### Activities Coming Soon

**Family Chess Nights** – Feb. 20 & March 20 | 6:30 p.m.–8 p.m.  
All levels and ages welcome. Young children must be accompanied by an adult.

**Read to a Dog** – March 4 | 1:30 p.m.-2:30 p.m.  
Young readers may read to a cuddly canine. Trained therapy dogs provided by Pets for Life, Inc. Check in upon arrival at Children’s Services for a reading time.

**After School LEGO Club** – March 13 | 4:30 p.m.–5:30 p.m.  
A new theme is introduced each month. Kindergarten through 5th grade. Registration is required.

Refer to the online calendar for other event information at the Downtown Library: [OlatheLibrary.org](http://OlatheLibrary.org)



### Indian Creek Library Teen Commons 16160 W. 135th St., near Feeney’s Hallmark

A new video gaming system for teens is coming in February. The system includes a 60-inch screen, Xbox One, Sony PlayStation, and Nintendo Switch gaming systems. For more information about the Teen Commons, call 913-971-6881.



# Earth News

from the City of Olathe, Kansas

## Volunteering Always in Season



*Each season brings opportunities to share your time and make the Olathe community even better.*

### Snow Brigade

Volunteers provide snow removal assistance to the elderly and residents with disabilities. The Snow Brigade will clear snow to entryways to help residents safely access their homes. Volunteers are activated within 24 to 48 hours of a snow event with accumulation of at least two inches.



*Girl Scouts from Mahaffie Elementary School are Adopt-A-Stream volunteers.*

### Adopt-A-Stream

Community groups can help keep the environment clean by collecting litter along streamways in Olathe. By volunteering for this service, you not only decrease litter and pollutants in the lakes and streams, you can also increase safety.



*Cub Scout Pack 3330 participates in Adopt-A-Street.*

### Adopt-A-Street

Schools, churches, businesses, and other groups help beautify Olathe by collecting litter along streets. Additional service can include removing graffiti and installing storm drainage identification.

#### **Benefits:**

"Adopted" streets have signs recognizing the adoption groups.

#### **NEW:**

Adopt-A-Street and Adopt-A-Stream volunteers will receive a free t-shirt!

#### **Additional Info:**

A responsible adult must organize and supervise the group.

The City will provide safety vests, trash bags, and gloves.

At the end of the collection, the City will collect all used trash bags.

### Volunteers in the Parks

Enjoy the outdoors while providing visible results in parks or along trails. Volunteers may landscape, garden, paint park equipment, or improve habitat for fish and wildlife.

Learn more about these and many other volunteer opportunities at [OlatheKS.org](http://OlatheKS.org). Select **I Want to... Volunteer**.

## Sign Up for Free Electronic Billing

City of Olathe water, wastewater, and solid waste customers are encouraged to sign up for free electronic billing.

Electronic billing customers receive an email link to their online account login page when the bill is generated each month. Customers have the option to pay their bill in person,

online, or mail their payment through the postal service.

Sign up at [OlatheKS.org/ElectronicBilling](http://OlatheKS.org/ElectronicBilling). Once an online account is set up, customers can track water and sewer usage and account balances.



## City Driving Cleaner, Greener Vehicles



The Olathe Public Works “Clean Fleet” of solid waste collection trucks are in full use – perhaps on your street. These Compressed Natural Gas (CNG)-powered vehicles are supporting a cleaner environment and saving money in the long-term by decreasing fossil fuel usage. Grant funding through the Mid-America Regional Council provided 80 percent of the CNG conversion costs on the solid waste collection trucks. There will be seven trucks using CNG in 2017 with a full conversion of all Olathe solid waste collection vehicles expected by 2025. In partnership with Johnson County Government, a new CNG fueling station located at Olathe Public Works is under construction.

Supplementing the “Clean Fleet” trucks are five all-electric Nissan Leaf cars. Each car saves an



estimated \$500 in fuel annually and has substantially reduced maintenance costs minus

oil and filter changes, and belt replacements. In addition, the City of Olathe has incorporated 15 hybrid vehicles in the fleet since the early 2000s.

Public electric vehicle charging stations are located at Olathe Public Works, 1385 S. Robinson Dr. and at Olathe City Hall, 100 E. Santa Fe St.

Visit [KCPL.com/CleanCharge](http://KCPL.com/CleanCharge) to view a map of additional charging stations in Olathe and throughout the nation.

### More Clean Fleet Initiatives

- New auxiliary heaters on service trucks are programmed to reduce warm-up time in cold weather, which result in lower fuel usage, fewer emissions, and time of staff.
- Larger batteries installed on fire and utility trucks help ensure the longevity of running emergency lights and computers.



Please remember property owners are responsible for clearing snow on sidewalks adjacent to their property.

**The Kansas City area has 1,000-plus electrical vehicle charging stations — more than any other U.S. city.**



### Reader Feedback

Please send your comments to:  
Olathe Link  
P.O. Box 768  
Olathe, KS 66051-0768  
linkcomments@OlatheKS.org  
913-971-8700

PRSRRT STD  
U.S. POSTAGE  
PAID  
Permit No. 323  
Olathe, KS

## Issues Affecting You

- Olathe — Celebrating 160 Years ..... 1
- Mayor's Message ..... 2
- Ward Boundary Adjustments ..... 3
- Park Plans Move Ahead ..... 4
- Changes Coming to Downtown Skyline .... 5
- Olathe Earth News ..... 6-7



Make an inquiry or request for City service 24/7  
**OlatheKS.org**—Click on *Connect With Us*.



Follow Us on Twitter  
Like Us on Facebook

Receive Olathe news and updates weekly. Look for *Newsletter* in the footer area at OlatheKS.org to subscribe. Additional newsletters are available at e-News under *OlatheConnect* at OlatheKS.org.

## Olathe Selected for What Works Cities

The City of Olathe is continually building on existing innovation for more effective local government. A concentrated effort will occur through 2018 as part of Olathe's selection to the national *What Works Cities* initiative.

Participation is highly competitive, with Olathe currently among 55 selected cities. Launched by Bloomberg Philanthropies, the program customizes approaches to help cities use data to address local issues.

The City of Olathe's focus includes developing ways to implement open data to strengthen public access to information. Secondly, various aspects of the City's performance management will be evaluated for recommendations, and employees will receive additional analytics training.

*What Works Cities* is providing Olathe technical assistance at no cost from two organizations: The Center for Government Excellence at Johns Hopkins University and the Sunlight Foundation. Having access to these excellent resources will help the City of Olathe work smarter with taxpayer dollars.

This initiative is one of the largest-ever philanthropic efforts to improve local governments' data and evidence practices.

## Have You Visited the New OlatheKS.org?

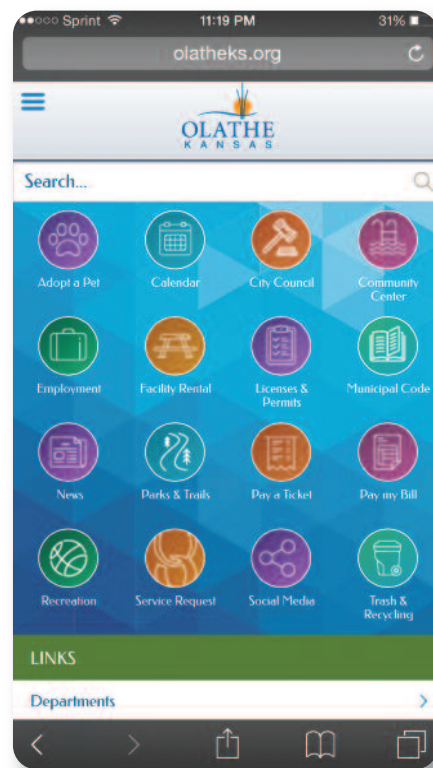

OlatheKS.org has a mobile-friendly, app-like view.

The new OlatheKS.org offers features and design that make the website's navigation easier across all platforms — full-size computer screens, tablets, or smart phones. The most frequently-requested service topics have one-click icons on the home page. Advanced search capability is offered through a prominent search bar.

Residents can send their best photos, videos, and stories and they could be featured on the website and social media. Send to Photos@OlatheKS.org.