

DWG: F:\2020\0001-0500\020-0217\40-Design\AutoCAD\Final Plans\Streets\ROBR\T_PLN01_0200217.dwg
 DATE: Dec 22, 2020 2:17pm XREFS: T_P1BLK_0200217 V_X10FO_200217 V_BNDY_200217

USER: jleek
 T_PSTRM_0200217
 T_PBASE_0200217
 T_PPATT_0200217

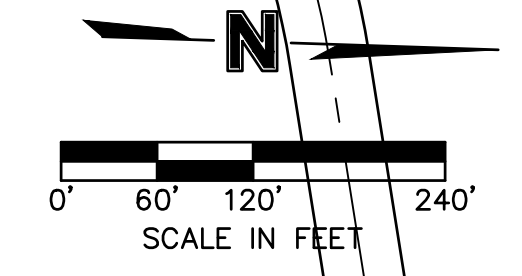
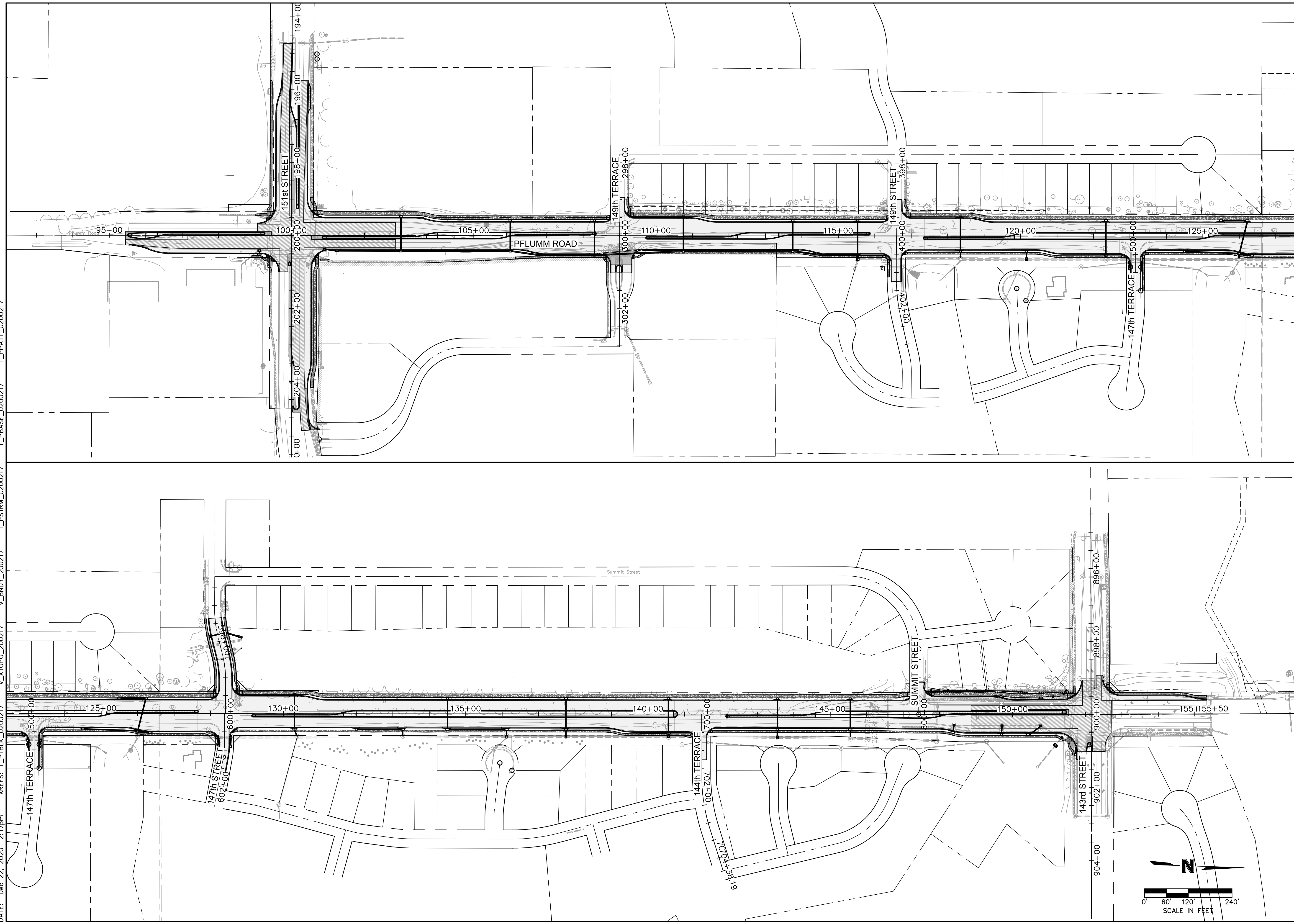

<p>olsson</p> <p>7301 West 133rd Street, Suite 200 Overland Park, KS 66213-4760 TEL 913.381.1170 FAX 913.381.1174 www.ollson.com</p>	
<p>60% PLANS NOT FOR CONSTRUCTION</p>	
<p>GENERAL LAYOUT PLAN</p>	<p>BY</p>
<p>PFLUMM ROAD, 143RD STREET TO 151ST STREET ROADWAY IMPROVEMENTS</p>	<p>REVISIONS DESCRIPTION</p>
<p>OLATHE, KANSAS</p>	<p>DATE</p>
<p>2020</p>	<p>REV. NO.</p>
<p>JKL AND CRW</p>	<p>REVISIONS</p>
<p>drawn by:</p>	<p>DATE</p>
<p>checked by:</p>	<p>REV. NO.</p>
<p>approved by:</p>	<p>REVISIONS DESCRIPTION</p>
<p>QA/QC by:</p>	<p>DATE</p>
<p>project no.: 020-0217</p>	<p>REV. NO.</p>
<p>drawing no.: T_PLN01_0200217</p>	<p>REVISIONS</p>
<p>date: 10.19.2020</p>	<p>DATE</p>
<p>SHEET 72 of 193</p>	<p>DATE</p>